

## Square Head Bolts

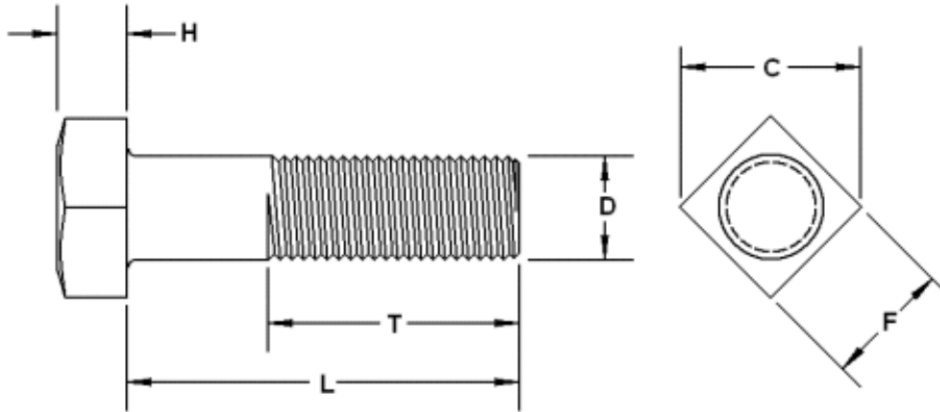

SAE Grade 2, ASTM A307

Plain = QB020-----

Zinc = QB020-----Z1

Galvanized = QB020-----GD

Bolt Diameter	D	F			C		H		
	Body Diameter	Width Across Flats			Width Across Corners		Height (Head)		
	Max	Basic	Max	Min	Max	Min	Basic	Max	Min
3/8	0.388	9/16	0.562	0.544	0.795	0.747	1/4	0.268	0.232
1/2	0.515	3/4	0.750	0.725	1.061	0.995	21/64	0.348	0.308
5/8	0.642	15/16	0.938	0.906	1.326	1.244	27/64	0.444	0.400
3/4	0.768	1-1/8	1.125	1.088	1.591	1.494	1/2	0.524	0.476
7/8	0.895	1-5/16	1.312	1.269	1.856	1.742	19/32	0.620	0.568
1	1.022	1-1/2	1.500	1.450	2.121	1.991	21/32	0.684	0.628
1-1/8	1.149	1-11/16	1.688	1.631	2.386	2.239	3/4	0.780	0.720
1-1/4	1.277	1-7/8	1.875	1.812	2.652	2.489	27/32	0.876	0.812
1-3/8	1.404	2-1/16	2.062	1.994	2.917	2.738	29/32	0.940	0.872
1-1/2	1.531	2-1/4	2.250	2.175	3.182	2.986	1	1.036	0.964

Dimensional specifications per ASME B18.2.1

**STANDARD THREAD LENGTH** Bolt lengths  $\leq 6''$ : Thread length = (2 X diameter) + 1/4"  
 Bolt lengths  $> 6''$ : Thread length = (2 X diameter) + 1/2"